

PARTS

PICTORIAL VIEWS

FRONT CORNER VIEW.....	PAGE 5-2
TOP VIEW.....	PAGE 5-3
FRONT PANEL VIEW.....	PAGE 5-4
INTERNAL TOP VIEW.....	PAGE 5-5
INTERNAL POWER PANEL VIEW.....	PAGE 5-6
POWER PANEL SIDE VIEW.....	PAGE 5-7
WELDMENT DRAWING VIEW.....	PAGE 5-8
HOOD ASSEMBLY VIEW.....	PAGE 5-9
COMBI-ADAPTER PARTS BREAKDOWN.....	PAGE 5-10

PARTS BY SECTION

AC CABLES & PLUG CONNECTORS.....	PAGE 5-11
BALANCER CASE PARTS.....	PAGE 5-11
BLOWER MOTORS (FAN).....	PAGE 5-12
CONTROL PANEL PARTS.....	PAGE 5-12
DECALS.....	PAGE 5-12
DRIVE MOTORS.....	PAGE 5-13
DRIVE PULLEYS.....	PAGE 5-13
HOOD & HOOD MOUNTING HARDWARE.....	PAGE 5-13
LABELS (SAFETY).....	PAGE 5-14
POWER PANEL ASSEMBLIES & INDIVIDUAL PARTS.....	PAGE 5-14
TRANSFORMERS.....	PAGE 5-14
WELDMENT ASSEMBLY & INDIVIDUAL PARTS.....	PAGE 5-15
STANDARD BALANCER ACCESSORIES.....	PAGE 5-15

WHEEL BALANCER OPTIONAL KIT ACCESSORIES

SMALL REVERSABLE CONE.....	PAGE 5-17
DEEP DISH OFFSET KIT.....	PAGE 5-17
7001 COMBI-ADAPTER KIT.....	PAGE 5-17
7002 UNIVERSAL ADAPTER KIT.....	PAGE 5-17
7003 UNIVERSAL 3 LUG ADAPTER KIT.....	PAGE 5-18
7004 UNIVERSAL 4 LUG ADAPTER KIT.....	PAGE 5-18
7005 UNIVERSAL 5 LUG ADAPTER KIT.....	PAGE 5-18
7006 OVERSIZE LUG NUTS KIT.....	PAGE 5-18
7007 WIRE WHEEL ADAPTER.....	PAGE 5-19
7009 UNIVERSAL ADAPTER KIT (3,4,5).....	PAGE 5-19
7011 BACK CONE MOUNTING KIT.....	PAGE 5-19
7012 UNIVERSAL ADAPTER KIT (4,5 METRIC).....	PAGE 5-19
7013 UNIVERSAL 3 LUG ADAPTER (METRIC).....	PAGE 5-20
7014 UNIVERSAL 4 LUG ADAPTER (METRIC).....	PAGE 5-20
7015 UNIVERSAL 5 LUG ADAPTER (METRIC).....	PAGE 5-20
7016 OVERSIZE LUG NUTS (10mm METRIC).....	PAGE 5-20
7017 COMBI-ADAPTER (METRIC).....	PAGE 5-21
7018 VW MOUNTING SYSTEM.....	PAGE 5-21
7019 UNIVERSAL ADAPTER KIT (3,4,5 METRIC).....	PAGE 5-21
7021 VW/PORSCHE MOUNTING KIT.....	PAGE 5-21
7026 ESCORT/LYNX WHEEL ADAPTER.....	PAGE 5-22

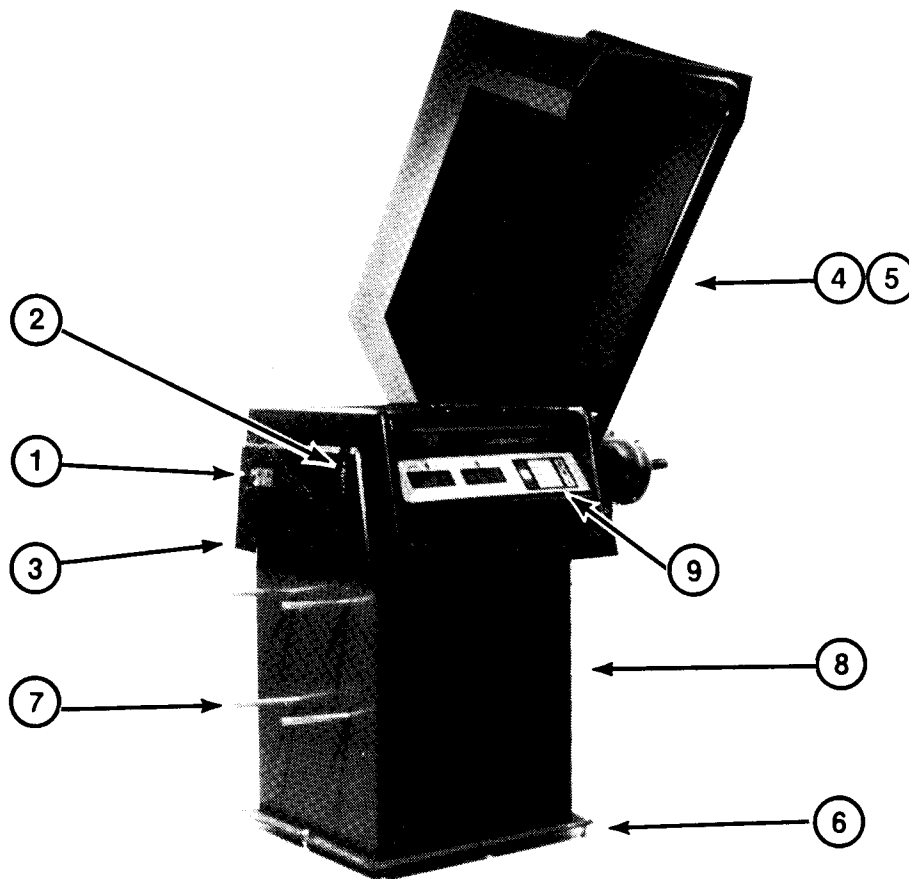

FRONT CORNER VIEW

1. ON/OFF SWITCH, 120V (WITH CIRCUIT BRK.).....2900-0007-01
ON/OFF SWITCH, 220V (WITH CIRCUIT BRK.).....2900-0007-03
ROUND SWITCH GUARD FOR ABOVE SWITCHES.....8004-0068
ON/OFF ROTARY SWITCH FOR 400V.....7300-1406-01
2. OZ/GRAM SWITCH.....0764-0213-01
Spring Retainer.....0764-0905
Bezel.....0764-0904
3. BALANCER CASE ONLY (PLASTIC 110/220V).....7006-0138
BALANCER CASE ONLY (400V).....7006-0138-01
4. SAFETY HOOD ONLY.....8004-0052
5. HOOD FRAME.....7023-0229
6. MOUNTING BOLT, 1/2" -13 X 1 1/2".....0675-0089
NUT, 1/2" -13.....0409-0088
LOCK WASHER.....0604-0035
7. PEGS (Quantity 4).....7300-1372-01
8. BASE, METAL.....7020-1781
PAINT, BLUE.....3550-0444
PAINT, RED.....3550-0445
PAINT, SILVER.....3550-0484
9. KEYPAD ASSEMBLY.....SEE PAGE 5-4

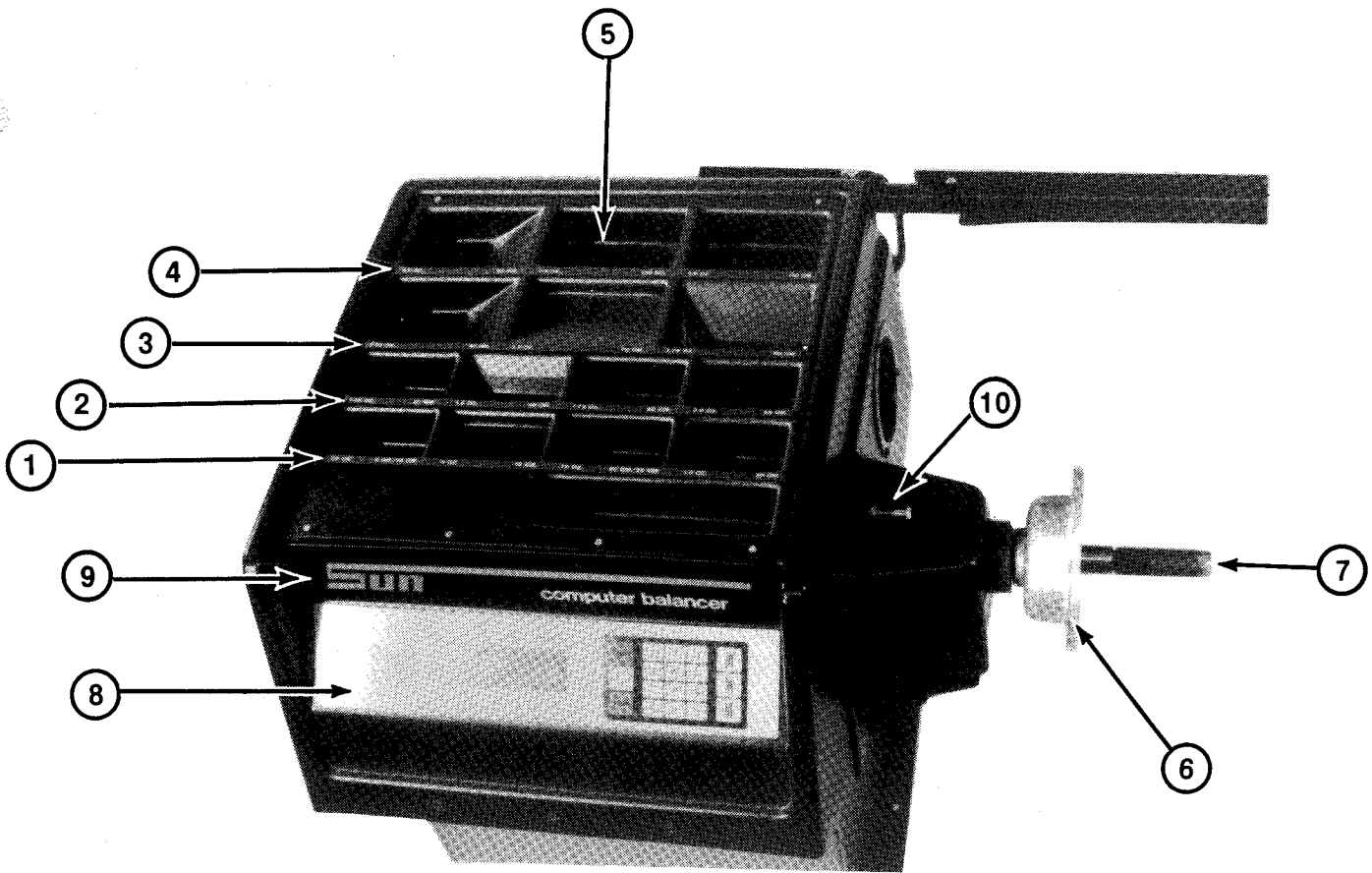

TOP VIEW

- | | | |
|-----|---|--------------|
| 1. | WEIGHT DECAL, .25 - 1.00 OZ/GMS..... | 0682-0645-01 |
| 2. | WEIGHT DECAL, 1.25 - 2.00 OZ/GMS..... | 0682-0645-02 |
| 3. | WEIGHT DECAL, 2.25 - 2.75 OZ/GMS..... | 0682-0645-03 |
| 4. | WEIGHT DECAL, 3.00 - 4.00 OZ/GMS..... | 0682-0645-04 |
| 5. | WEIGHT TRAY..... | 7022-0084 |
| | Support Rod (Not Shown)..... | 0652-0382 |
| 6. | MAINSHAFT & FACEPLATE..... | 7400-1106-01 |
| 7. | STUB SHAFT, LONG (STANDARD 6.44 IN.)..... | 7000-6670-02 |
| | LONG STUB SHAFT IS USED WITH QUICK RELEASE HANDLE | |
| | STUB SHAFT, SHORT (4.75 IN.)..... | 7024-0413-01 |
| 8. | CONTROL PANEL ASSEMBLY..... | SEE PAGE 5-4 |
| 9. | "SUN" DECAL..... | 0682-0713. |
| 10. | DISTANCE GAUGE ASSEMBLY..... | SEE PAGE 5-5 |

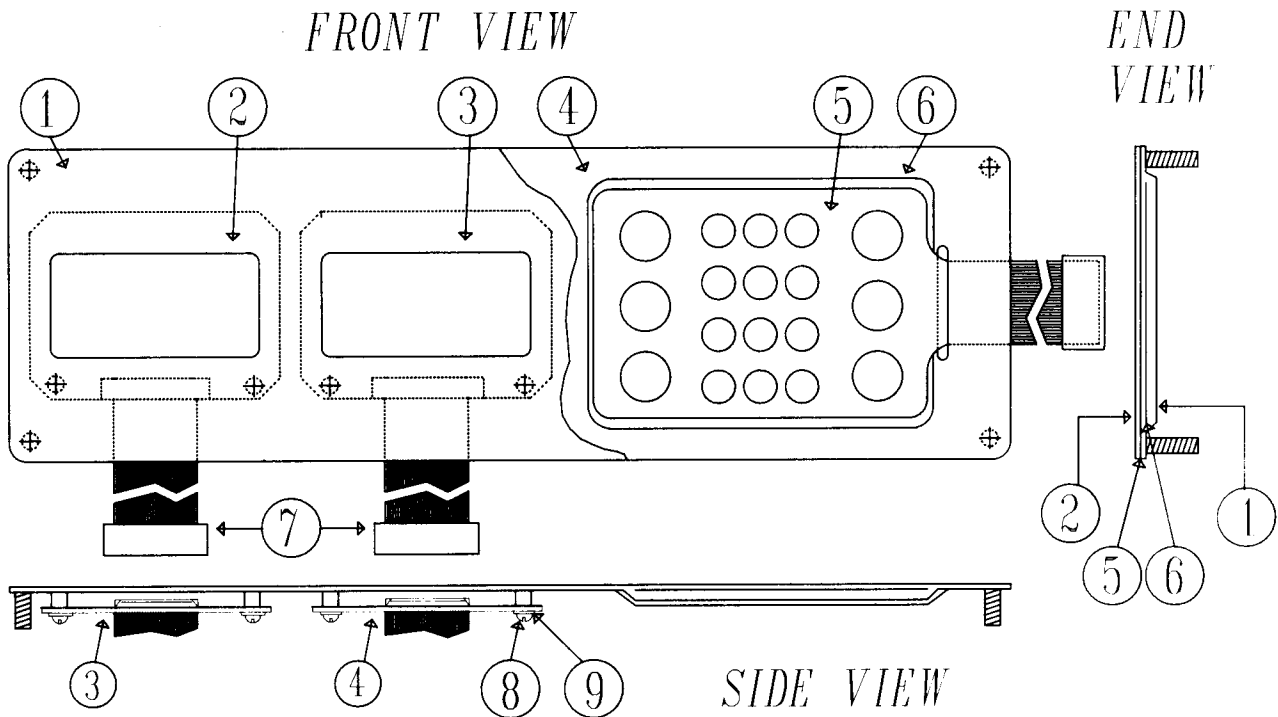

FRONT PANEL VIEW

- 1. CONTROL PANEL COMPLETE ASSEMBLY.....7009-1765
CONTROL PANEL (Sheet Metal Only).....7020-1762
- 2. INNER WEIGHT DISPLAY PCB with 42" cable.....7001-0495
- 3. OUTER WEIGHT DISPLAY PCB with 42" cable.....7001-0496
- 4. OVERLAY, CONTROL PANEL DECAL.....4055-0209
- 5. KEYPAD.....7400-1340-01
Keypad Extension Cable (W2).....7076-0466
- 6. RUBBER KEYPAD CUSHION.....7400-1424-01
- 7. DISPLAY EXT. CABLE (early machines only).....6004-0429
- 8. SCREW, MACH 6-32 X 1/4 PAN.....0406-0132
- 9. WASHER, LOCK #6.....0604-0006

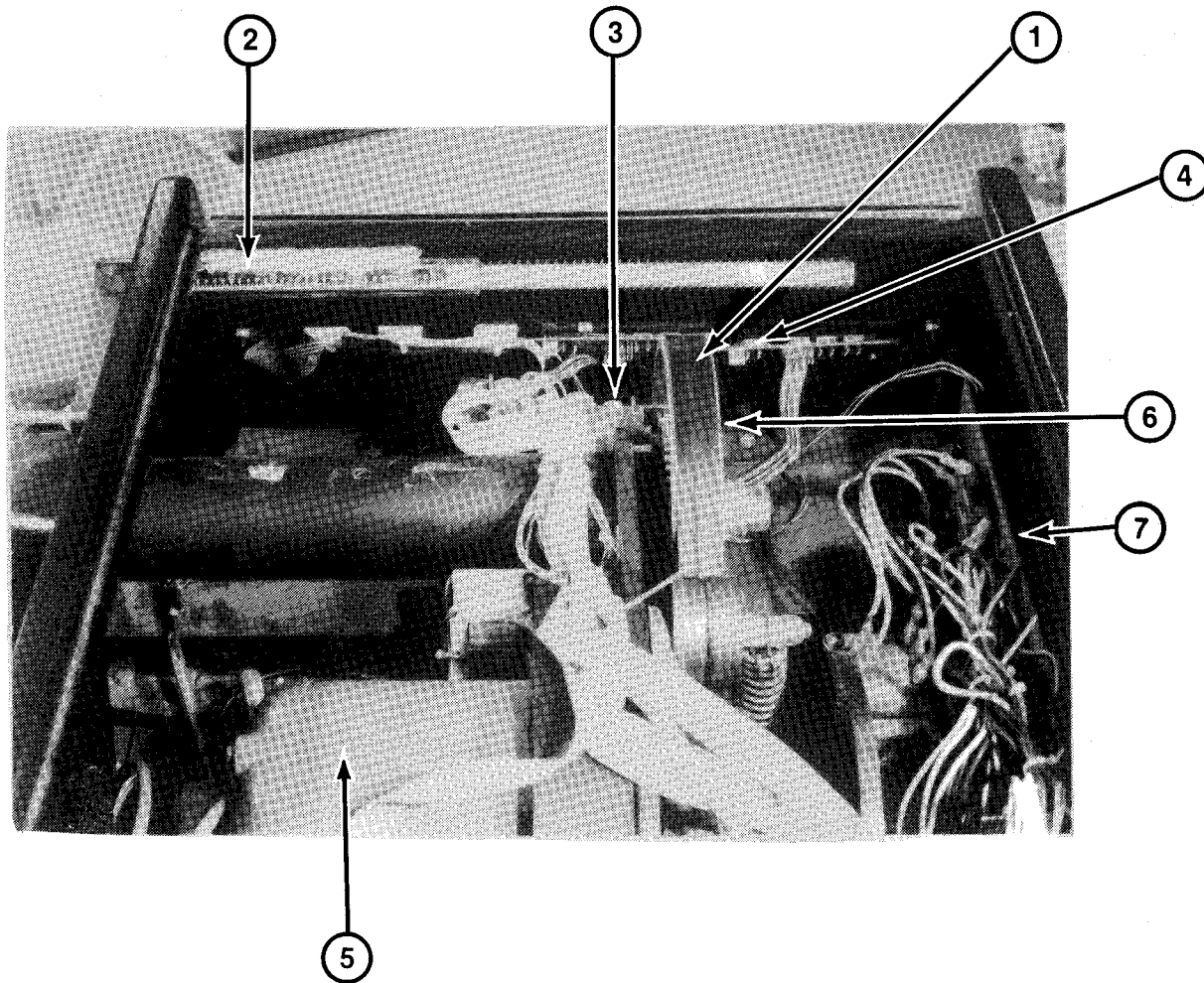

INTERNAL VIEW

- | | | |
|----|---|--------------|
| 1. | DRIVE BELT, 36 IN..... | 3803-0001-05 |
| 2. | DISTANCE GAUGE ASSEMBLY..... | 7400-1299-01 |
| | DISTANCE GAUGE SPRING..... | 7400-1125-01 |
| | DISTANCE GAUGE TUBE..... | 7400-1120-01 |
| | GLUE FOR GAUGE TUBE..... | 0626-0066 |
| | Adhesive Activator for Glue..... | 0626-0065 |
| 3. | OPTICAL TIMER ASSEMBLY (O.T.A)..... | 7300-1239-01 |
| 4. | INNER DISPLAY PCB (with 42" cable)..... | 7001-0495 |
| | OUTER DISPLAY PCB (with 42" cable)..... | 7001-0496 |
| 5. | AC MOTOR, 120V, 60HZ, 1 PHASE..... | 7009-1705-01 |
| | AC MOTOR, 220V, 60HZ, 3 PHASE..... | 7300-1312-01 |
| | AC MOTOR, 220V, 50HZ, 1 PHASE..... | 7009-1705-03 |
| | AC MOTOR, 400V, 50HZ, 3 PHASE..... | 7300-1312-03 |
| 6. | SLOTTED PULLEY, 60HZ (8.020 Dia.)..... | 7400-1332-02 |
| | SLOTTED PULLEY, 50HZ (7.770 Dia.)..... | 7400-1332-01 |
| 7. | POWER PANEL..... | SEE PAGE 5-6 |

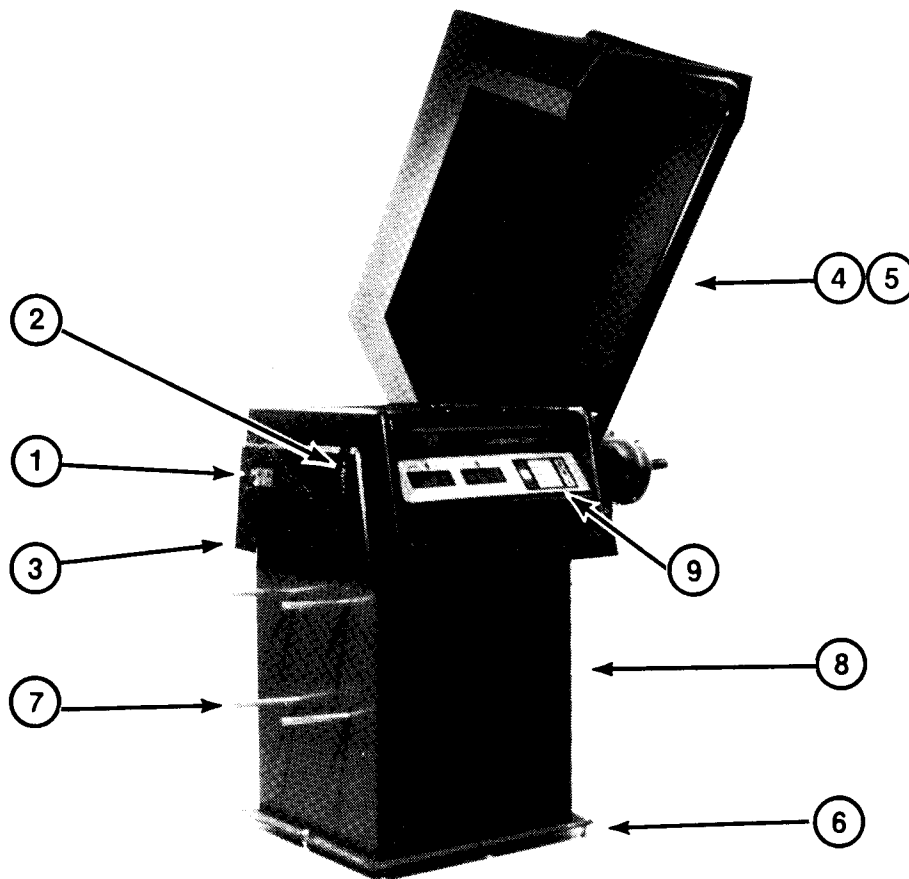

FRONT CORNER VIEW

1. ON/OFF SWITCH, 120V (WITH CIRCUIT BRK.).....2900-0007-01
ON/OFF SWITCH, 220V (WITH CIRCUIT BRK.).....2900-0007-03
ROUND SWITCH GUARD FOR ABOVE SWITCHES.....8004-0068
ON/OFF ROTARY SWITCH FOR 400V.....7300-1406-01
2. OZ/GRAM SWITCH.....0764-0213-01
Spring Retainer.....0764-0905
Bezel.....0764-0904
3. BALANCER CASE ONLY (PLASTIC 110/220V).....7006-0138
BALANCER CASE ONLY (400V).....7006-0138-01
4. SAFETY HOOD ONLY.....8004-0052
5. HOOD FRAME.....7023-0229
6. MOUNTING BOLT, 1/2" -13 X 1 1/2".....0675-0089
NUT, 1/2" -13.....0409-0088
LOCK WASHER.....0604-0035
7. PEGS (Quantity 4).....7300-1372-01
8. BASE, METAL.....7020-1781
PAINT, BLUE.....3550-0444
PAINT, RED.....3550-0445
PAINT, SILVER.....3550-0484
9. KEYPAD ASSEMBLY.....SEE PAGE 5-4

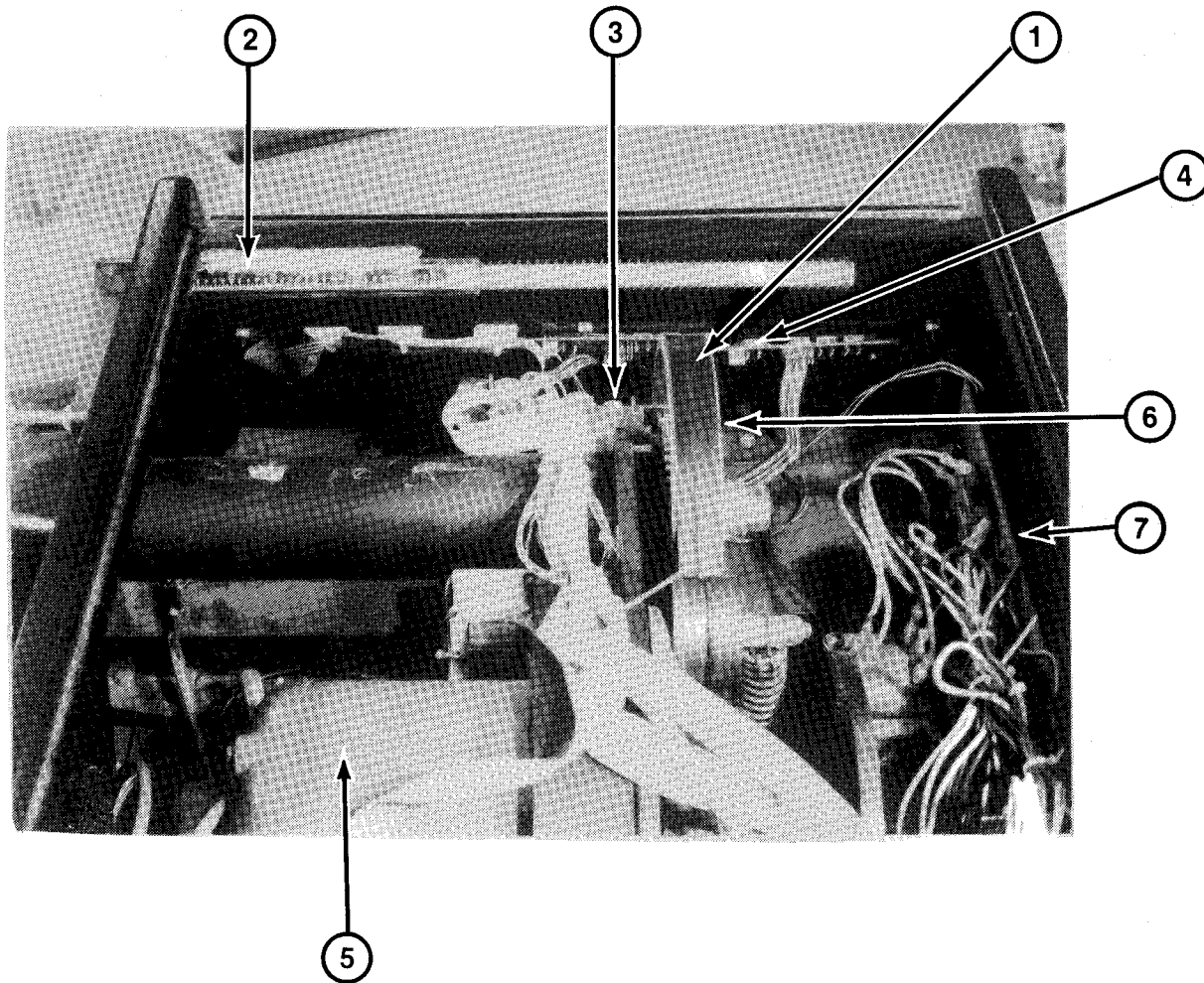

INTERNAL VIEW

- | | | |
|----|---|--------------|
| 1. | DRIVE BELT, 36 IN..... | 3803-0001-05 |
| 2. | DISTANCE GAUGE ASSEMBLY..... | 7400-1299-01 |
| | DISTANCE GAUGE SPRING..... | 7400-1125-01 |
| | DISTANCE GAUGE TUBE..... | 7400-1120-01 |
| | GLUE FOR GAUGE TUBE..... | 0626-0066 |
| | Adhesive Activator for Glue..... | 0626-0065 |
| 3. | OPTICAL TIMER ASSEMBLY (O.T.A)..... | 7300-1239-01 |
| 4. | INNER DISPLAY PCB (with 42" cable)..... | 7001-0495 |
| | OUTER DISPLAY PCB (with 42" cable)..... | 7001-0496 |
| 5. | AC MOTOR, 120V, 60HZ, 1 PHASE..... | 7009-1705-01 |
| | AC MOTOR, 220V, 60HZ, 3 PHASE..... | 7300-1312-01 |
| | AC MOTOR, 220V, 50HZ, 1 PHASE..... | 7009-1705-03 |
| | AC MOTOR, 400V, 50HZ, 3 PHASE..... | 7300-1312-03 |
| 6. | SLOTTED PULLEY, 60HZ (8.020 Dia.)..... | 7400-1332-02 |
| | SLOTTED PULLEY, 50HZ (7.770 Dia.)..... | 7400-1332-01 |
| 7. | POWER PANEL..... | SEE PAGE 5-6 |

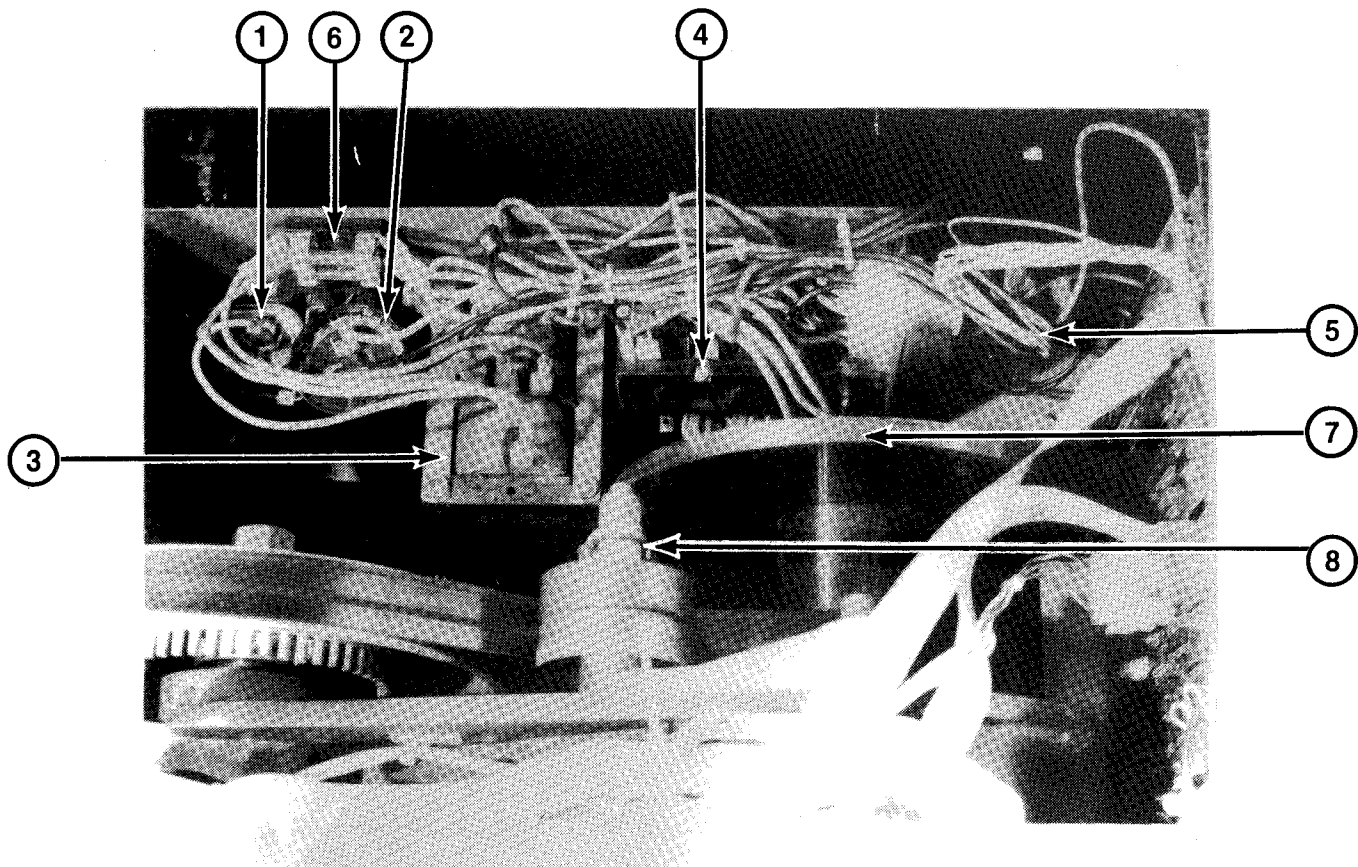

INTERNAL POWER PANEL VIEW

- 1. CAPACITOR (C1,ELCTLT), SILVER, Transformer.....2102-0002-01
- 2. START CAPACITOR (C102,ELCTLT).....2102-0001-01
- 3. TRANSFORMER 120V, 60HZ, 1 PHASE.....0778-0471
 TRANSFORMER 220V, 60HZ, 3 PHASE.....2601-0010-01
 TRANSFORMER 220V, 50HZ, 1 PHASE.....2601-0012-01
 TRANSFORMER 400V, 50HZ, 3 PHASE.....2601-0012-01
- 4. CONTACTOR (K101, 110/220V).....2700-0002-01
 CONTACTOR with MICROSWITCH (K101, 400V).....2700-0001-01
- 5. BRIDGE RECTIFIER, 800V.....2202-0004-01
 VARISTER ACROSS BRIDGE (VR101), 275V.....7009-1776
- 6. FUSE HOLDER.....3904-0001-01
 FUSE, 3 AMP (F101, F102).....0739-0103
- 7. FLYWHEEL.....7400-1068-01
- 8. IDLER ARM ASSEMBLY.....7400-1278-01
 IDLER ARM SPRING.....7400-1219-01

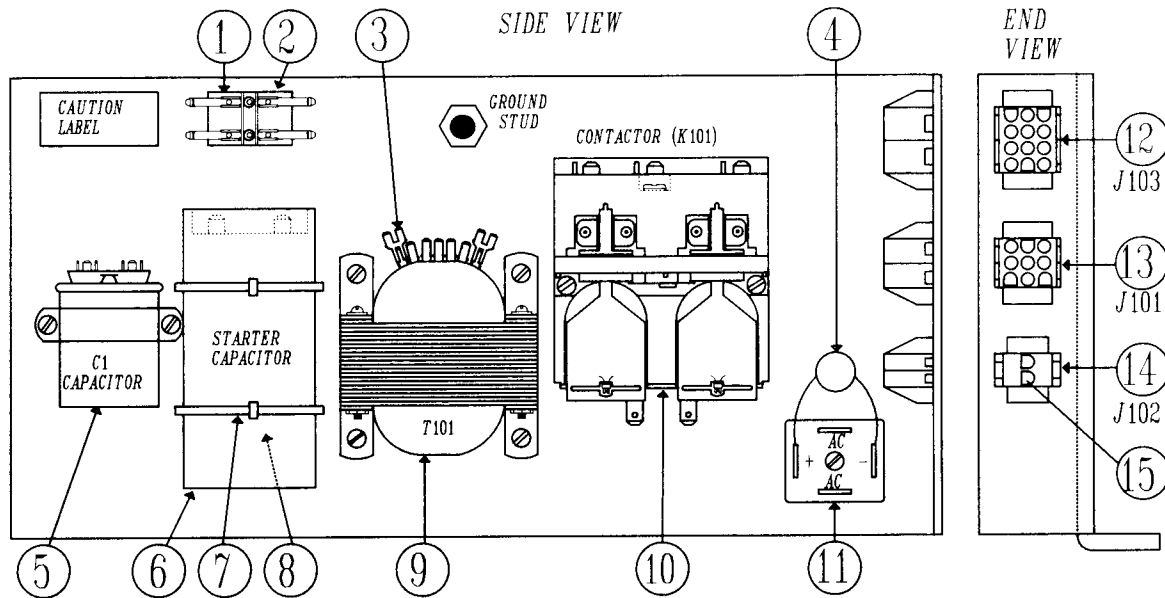

POWER PANEL SIDE VIEW

1. FUSE HOLDER, XF101.....3904-0001-01
2. FUSE, 3 AMP, F101, F102.....0739-0103
3. RECEPTICAL, DUAL TAB.....2806-0002-01
4. VARISTOR, VR101.....7009-1776
5. SILVER CAPACITOR, ELCTLT C1,(Replace w/Transformer).2102-0002-01
6. START CAPACITOR, ELCTLT C102.....2102-0001-01
7. CAPACITOR HOLD-UP STRAPS.....5878-0011
8. STICKER MOUNTS FOR HOLD-UP STAPS, (Not Shown).....5878-0902
9. TRANSFORMER (T101), 120/220V, 60HZ.....0778-0471
TRANSFORMER (T101), 220V, 50HZ.....2601-0012-01
10. CONTACTOR, K101, 120/220V.....2700-0002-01
CONTACTOR, K101, 220/400V, 50HZ.....2700-0001-01
11. BRIDGE RECTIFIER, 800V, CR101.....2202-0004-01
12. CONNECTOR BODY, RCPT (FEMALE 12 PIN), J103.....4162-0332
13. CONNECTOR BODY, RCPT (FEMALE 9 PIN), J101.....4162-0379
14. CONNECTOR BODY, RCPT (FEMALE 2 PIN), J102.....4162-0331
15. FEMALE CONTACT SOCKET FOR #'s 12, 13, 14.....4162-0573

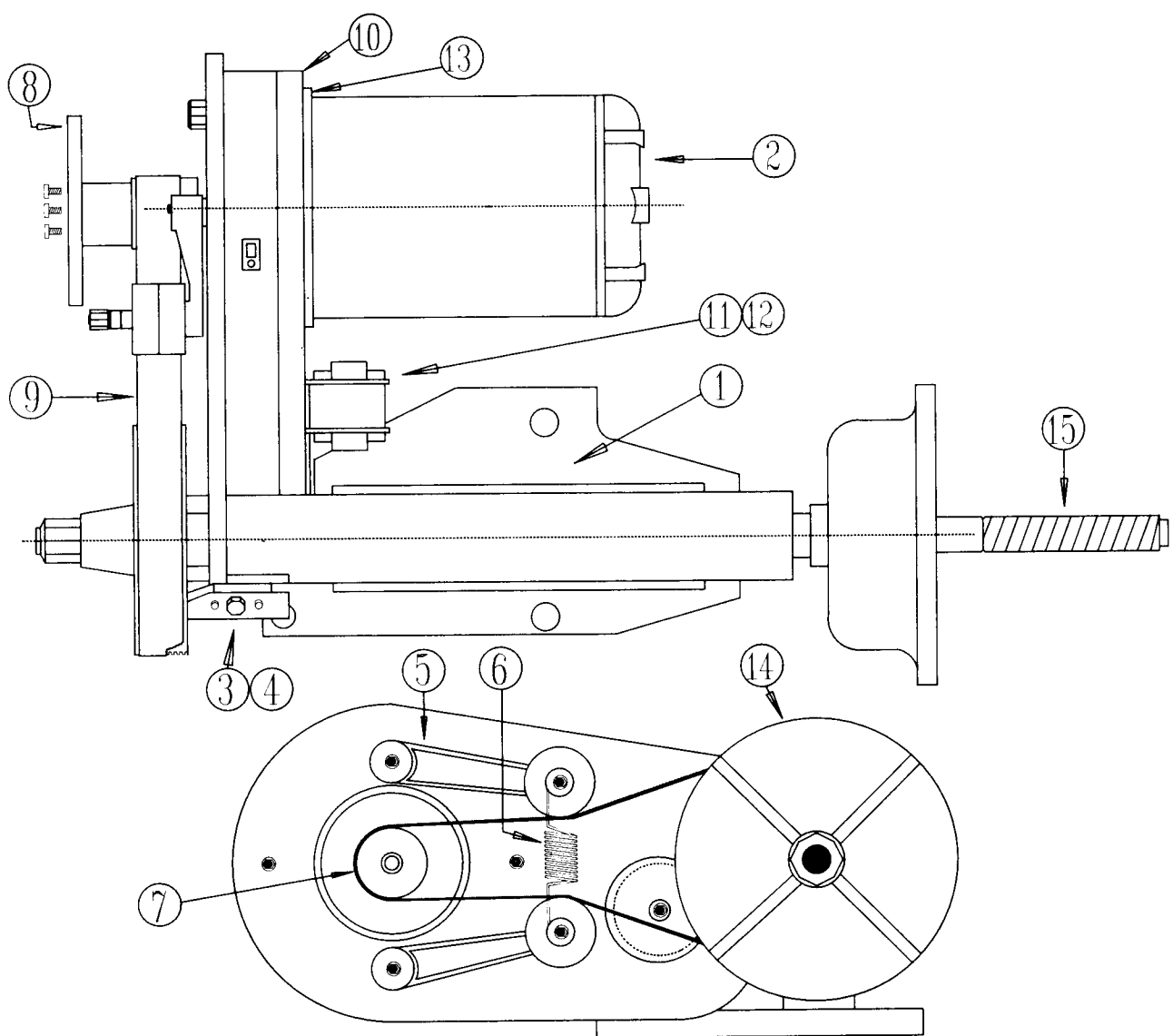

WELDMENT DRAWING VIEW

1. TRANSDUCER/SHAFT ASSY (Minus Motor).....7400-1099-01
2. MOTOR ASSY. 120V, 60HZ, 1 PHASE.....7009-1705-01
MOTOR ASSY. 220V, 60HZ, 3 PHASE.....7300-1312-01
MOTOR ASSY. 400V, 50HZ, 3 PHASE.....7300-1312-03
MOTOR ASSY. 220V, 50HZ, 1 PHASE.....7009-1705-03
3. OPTICAL TIMING ASSEMBLY.....7300-1239-01
4. SPACER (O.T.A.).....7300-1471-02
5. IDLER ARM ASSEMBLY.....7400-1278-01
6. IDLER SPRING ASSEMBLY.....7400-1219-01
7. PULLEY, 120V, 60HZ, 1 PHASE.....7400-1069-01
PULLEY, 220V, 60HZ, 3 PHASE.....7300-1387-04
PULLEY, 400V, 50HZ, 3 PHASE.....7300-1387-05
PULLEY, 220V, 50HZ, 1 PHASE.....7400-1069-02
8. FLYWHEEL, DRIVE PULLEY, 120V, 1 Phase.....7400-1068-01
Cap Screw (Flywheel) 10/32 x 1/2".....4022-0106-06
9. BELT, DRIVE 36 INCH.....3803-0001-05
10. SHROUD WELD ASSEMBLY.....7020-1791
11. BLOWER MOTOR ASSY. 120V.....7300-1478-02
BLOWER MOTOR ASSY. 220V.....7300-1478-01
BLOWER MOTOR ASSY. 400V.....7300-1478-03
12. WHEEL, BLOWER.....3821-0002-01
13. GASKET, RUBBER.....7300-1278-01
14. SLOTTED PULLEY 60HZ (8.020 Dia.).....7400-1332-02
SLOTTED PULLEY 50HZ (7.770 Dia.).....7400-1332-01
15. STUB SHAFT, LONG 6.44 IN., STANDARD.....7000-6670-02

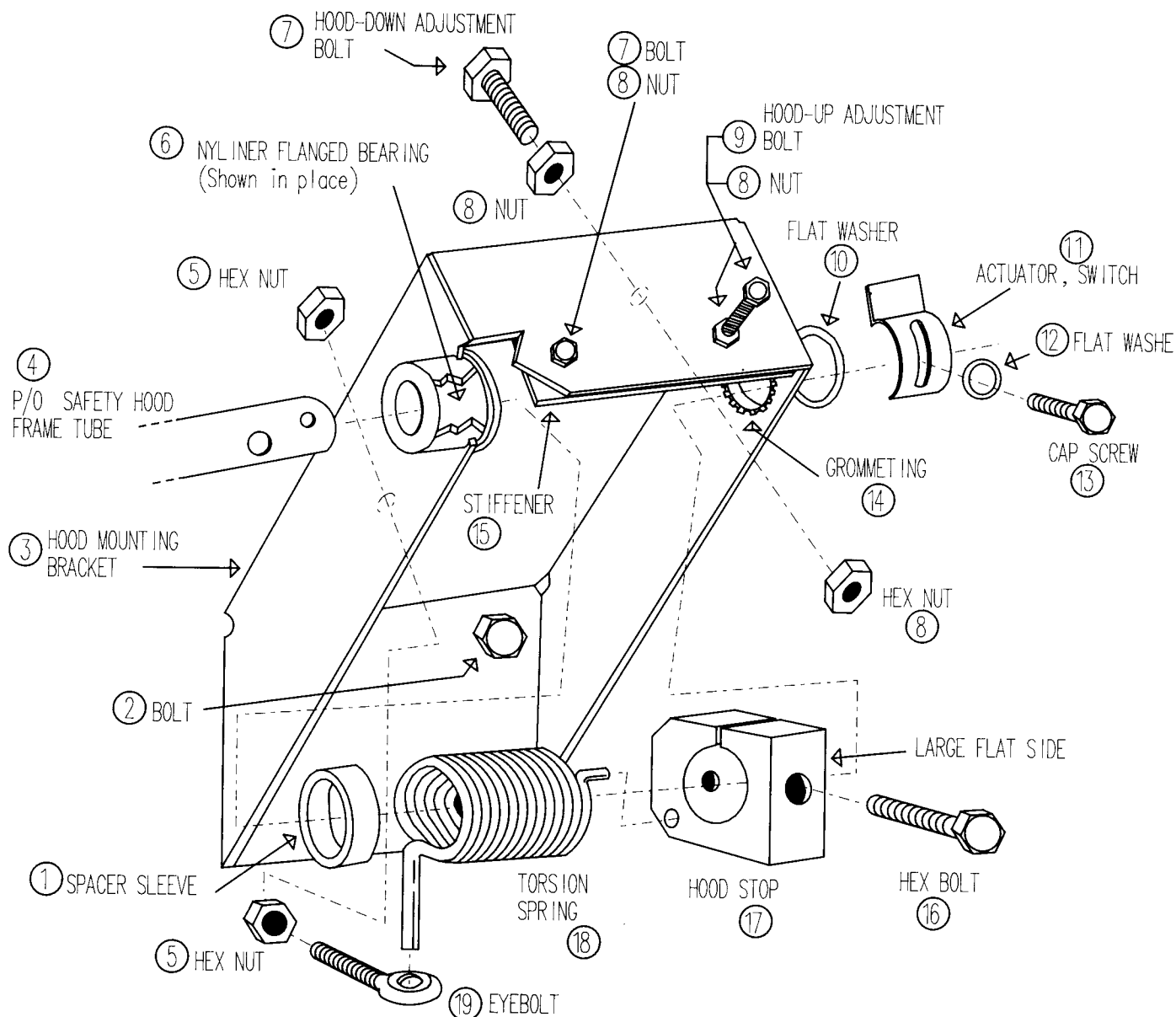

HOOD MOUNTING HARDWARE

1. SPACER SLEEVE.....	0401-0371
2. BOLT (1/2x13x1.5).....	0675-0089
3. HOOD MOUNTING BRACKET.....	1720-1742
4. SAFETY HOOD FRAME TUBE.....	7023-0229
5. HEX NUT (5/16x18).....	0409-0043
6. NYLINER FLANGED BEARING.....	3802-0001-01
7. BOLT (3/8x16x1.25).....	0675-0070
8. HEX NUT (3/8x16).....	0409-0113
9. BOLT (3/8x16x2).....	0675-0449
10. FLAT WASHER.....	7000-6900-01
11. ACTUATOR SWITCH.....	7007-0006
12. FLAT WASHER (1/4" ID).....	0400-0501
13. CAP SCREW (1/4x20x1).....	4022-0107-10
14. PLASTIC GROMMETING 5".....	3807-0003-04
15. STIFFENER.....	7003-0531
16. BOLT (3/8x16x3).....	0675-0073
17. HOOD STOP.....	7430-2032-01
18. TORSION SPRING.....	3825-0014-01
19. EYEBOLT (5/16x18).....	4010-0001-01

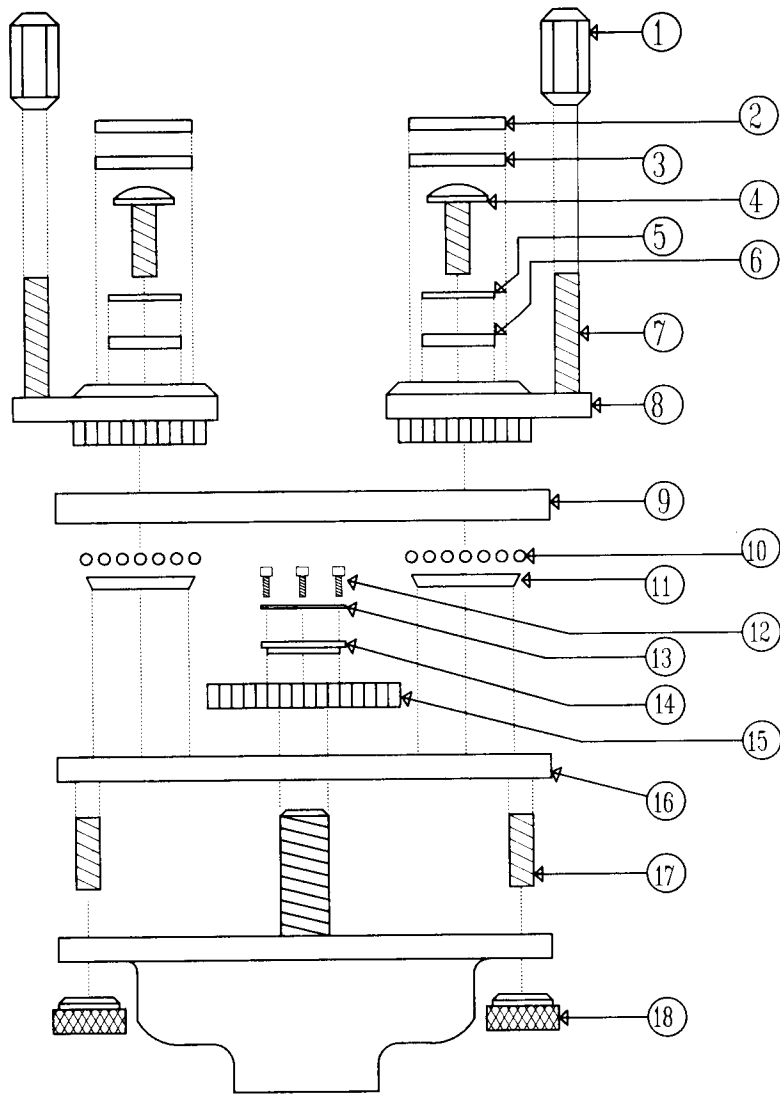

COMBI-ADAPTER PARTS BREAKDOWN

1.	Lug Nut, Standard.....	7000-6350-01
2.	Retaining Ring.....	3805-0001-01
3.	Seal.....	7000-7000
4.	Swivel Screw.....	7000-6990-01
5.	Thrust Race.....	3702-0002-01
6.	Thrust Bearing.....	3702-0001-01
7.	Stud, Standard.....	7000-6710-01
8.	Swivel Plate.....	7000-8070-01
9.	Adapter Cover	
	(3 Lug).....	7000-5723-01
	(4 Lug).....	7000-5721-01
	(5 Lug).....	7000-5722-01
10.	Ball 5/32.....	3703-0001-01
11.	Ball Race.....	7000-7200
12.	Socket Head Screw.....	4022-0104-06
13.	Adapter Label.....	7000-6490
14.	Retaining Ring.....	7100-3150-01
15.	Gear.....	7100-3209-01
16.	Adapter Plate	
	(3 Lug).....	7000-8078-01
	(4 Lug).....	7000-8074-01
	(5 Lug).....	7000-8075-01
17.	Set Screw.....	4023-0109-10
18.	Face Plate Nut.....	7000-6360-01

SECTION II. CWB-1762 PARTS BY SECTION

DESCRIPTION	PART NUMBER
AC CABLES & PLUG CONNECTORS	
AC POWER CORD, 120V, 60HZ 1 PHASE.....	6001-0164-01
AC POWER CORD, 220V, 60HZ 3 PHASE.....	6001-0165
AC POWER CORD, 400V, 50HZ.....	6001-0166
AC PLUG, 120V, 15A.....	0825-0020
AC PLUG, 220V, 20A.....	2803-0005-01
BALANCER CASE PARTS	
ON/OFF SWITCH, 120V WITH CIRCUIT BRK, 1 AMP.....	2900-0007-01
ON/OFF SWITCH, 220V WITH CIRCUIT BRK, .5 AMP.....	2900-0007-03
ON/OFF ROTARY SWITCH, 400V.....	7300-1406-01
SWITCH GAURD, FOR ON/OFF CIRCUIT BRK.....	8004-0068
OZ/GRAM SWITCH.....	0764-0213-01
BEZEL, OZ/GRAM SWITCH.....	0764-0904
SPRING, BEZEL RETAINER.....	0764-0905
CLIP, SPRING TENSION, OZ/GRAM SWITCH.....	7032-0166
RIM DISTANCE GAUGE ASSEMBLY.....	7400-1299-01
RIM DISTANCE GAUGE SPRING.....	7400-1125-01
RIM DISTANCE GAUGE TUBE.....	7400-1120-01
Glue for Gauge Tube.....	0626-0066
Adhesive Activator for Glue.....	0626-0065
CASE ONLY, PLASTIC, 120V/220V.....	7006-0138
CASE ONLY, PLASTIC, 400V.....	7006-0138-01
WEIGHT TRAY.....	7022-0084
Support Rod for Weight Tray.....	0652-0382
EXHAUST VENT ASSEMBLY.....	7020-1737
FUSE HOLDER, 400V.....	7400-1327-01
FUSE, .75 AMP, 400V.....	0739-0082

BLOWER MOTORS (FAN)

BLOWER MOTOR, 220V, 60HZ, 3 PHASE.....7300-1478-01
BLOWER MOTOR, 220V, 50HZ, 1 PHASE
BLOWER MOTOR, 120V, 60HZ, 1 PHASE.....7300-1478-02
BLOWER MOTOR, 400V, 50HZ, 3 PHASE.....7300-1478-03

CONTROL PANEL PARTS

MAIN FUNCTION CPU BOARD.....7001-0392
CONTROL PANEL ASSEMBLY (INCL DISPLAYS).....7009-1765
KEYPAD.....7400-1340-01
Extension Cable (W2).....7076-0466
RUBBER KEYPAD CUSHION.....7400-1424-01
CONTROL PANEL OVERLAY.....4055-0209
INNER LED DISPLAY.....7001-0495
OUTER LED DISPLAY.....7001-0496
36" DISPLAY EXTENSION CABLE (early models only).....6004-0431

DECALS

OVERLAY, CONTROL PANEL DECAL.....4055-0209
HEADSIGN, SUN LOGO; ORANGE/BLK/RED.....0682-0713
HEADSIGN, ATLAS LOGO.....0753-0133
HEADSIGN, ROTUNDA LOGO.....0753-0134
HOOD, STRIPES & 1762; ORANGE/BLK/RED.....0682-0714
HOOD, STIPES ONLY; ORANGE/BLK/RED.....0682-0720
HOOD, SUN LOGO.....0753-0132
HOOD, ATLAS LOGO, ANL-84.....0753-0135
HOOD, ROTUNDA LOGO.....0753-0136
WEIGHT DECAL, .25 - 1.00 OZ/GMS.....0682-0645-01
WEIGHT DECAL, 1.25 - 2.00 OZ/GMS.....0682-0645-02
WEIGHT DECAL, 2.25 - 2.75 OZ/GMS.....0682-0645-03
WEIGHT DECAL, 3.00 - 4.00 OZ/GMS.....0682-0645-04

DRIVE MOTORS

MOTOR ASSEMBLY, 120V, 60HZ, 1 PHASE.....7009-1705-01
MOTOR ASSEMBLY, 220V, 60HZ, 3 PHASE.....7300-1312-01
MOTOR ASSEMBLY, 400V, 50HZ, 3 PHASE.....7300-1312-03
MOTOR ASSEMBLY, 220V, 50HZ, 1 PHASE.....7009-1705-03

DRIVE PULLEYS

DRIVE PULLEY, 120V, 60HZ, 1 PHASE.....7400-1069-01
DRIVE PULLEY, 220V, 60HZ, 3 PHASE.....7300-1387-04
DRIVE PULLEY, 400V, 50HZ, 3 PHASE.....7300-1387-05
DRIVE PULLEY, 220V, 50HZ, 1 PHASE.....7400-1069-02

HOOD & HOOD MOUNTING HARDWARE

HOOD MICROSWITCH, S2, S3.....2912-0001-02
MICROSWITCH CABLE.....6004-0430
MICROSWITCH COVER.....7014-0151
SAFETY HOOD, ONLY.....8004-0052
SAFETY HOOD FRAME.....7023-0229
HOOD BRACKET WELD ASSEMBLY.....7020-1742
GROMMETING, 5 INCHES.....3807-0003-04
ACTUATOR, HOOD SWITCH.....7007-0006
NYLINER FLANGED BEARING.....3802-0001-01
TORSION SPRING.....3825-0014-01
EYEBOLT (5/16 X 18).....4010-0001-01
HOOD STOP.....7430-2032-01
FLAT WASHER, 2 INCH.....7000-6900-01
SPACER SLEEVE.....0401-0371

LABELS (SAFETY)

WARNING LABEL.....1000-0032-01
DANGER HIGH VOLTAGE LABEL.....1000-0033-01
ON/OFF LABEL.....1000-0034-01
USE NO LUBRICANTS LABEL.....7300-1403-01

POWER PANEL ASSEMBLIES & INDIVIDUAL PARTS

COMPLETE POWER PANEL, 120V, 60HZ, 1 PH.....7009-1766-01
COMPLETE POWER PANEL, 220V, 60HZ, 3 PH.....7009-1768-01
COMPLETE POWER PANEL, 400V, 50HZ, 3 PH.....7009-1768-02
COMPLETE POWER PANEL, 220V, 50HZ, 1 PH.....7009-1766-02
SILVER CAPACITOR, C101.....2102-0002-01
START CAPACITOR, C102.....2102-0001-01
BRIDGE RECTIFIER, 800V, ALL 1 PHASE.....2202-0004-01
FUSE HOLDER, ALL MODELS/except 400V.....3904-0001-01
FUSE, POWER SUPPLY, 3 AMP.....0739-0103
FUSE HOLDER, 400V.....7400-1327-01
FUSE, 400V, .75 AMP.....0739-0082
VARISTOR (VR101), 275V ACROSS BRIDGE, 1 PH.....7009-1776
VARISTOR, ON CONTACTOR, 400V ONLY.....2201-0004-01
CONTACTOR, K101, ALL EXCEPT 400V.....2700-0002-01
CONTACTOR, K101, 400V ONLY.....2700-0001-01

TRANSFORMERS

TRANSFORMER, 120V, 60HZ, 1 PHASE.....0778-0471
TRANSFORMER, 220V, 60HZ, 3 PHASE.....2601-0010-01
TRANSFORMER, 400V, 50HZ, 3 PHASE.....2601-0012-01
TRANSFORMER, 220V, 50HZ, 1 PHASE

WELDMENT ASSEMBLY & INDIVIDUAL PARTS

COMPLETE WELDMENT ASSEMBLY (Minus Motor).....7400-1099-01
DRIVE BELT, 36 INCH.....3803-0001-05
OVERLOAD PLUG.....7400-1166-01
"O" RING, for Overload Plug.....4007-0004-01
STUB SHAFT, LONG (Standard).....7000-6670-02
STUB SHAFT, SHORT.....7024-0413-01
OPTICAL TIMER, (OTA).....7300-1239-01
MOUNTING BLOCK, OPTICAL TIMER.....7300-1471-02
MAINSHAFT & FACEPLATE.....7400-1106-01
IDLER ARM ASSEMBLY.....7400-1278-01
IDLER ARM SPRING.....7400-1219-01
FLYWHEEL, 1 PHASE.....7400-1068-01
Cap Screw (Flywheel, Qty. 3), 10/32 x 1/2.....4022-0106-06
WOODRUFF KEY, MAINSHAFT.....3808-0001-01
RETAINER RING.....3805-0004-01
BALL BEARING.....3701-0002-01
SLOTTED PULLEY, 60HZ.....7400-1332-02
SLOTTED PULLEY, 50HZ.....7400-1332-01
SHIM, MAINSHAFT, .015 INCHES.....3805-0005-01
SHIM, MAINSHAFT, .015 INCHES.....3805-0005-02
SHIM, MAINSHAFT, .024 INCHES.....3805-0005-03
SHIM, MAINSHAFT, .075 INCHES.....3805-0005-04

STANDARD BALANCER ACCESSORIES

HUBNUT ASSEMBLY, QUICK RELEASE.....7009-1715
Halves, Hubnut (Right).....7024-0415-01
Halves, Hubnut (Left).....7024-0415-02
Spring, Helical Compression.....0711-0234
Pin, Staight Headless.....0275-0006
HUBNUT, TRI-STAR.....7300-1578-01
CALIPER ASSEMBLY.....7400-1177-02
NO-MAR RING, PLASTIC.....7300-1597-01

STANDARD ACCESSORIES CONTINUED:

SPRING, MOUNTING.....3825-0002-01
CONE, SMALL.....7300-1575-01
CONE, MEDIUM.....7300-1575-02
CONE, LARGE.....7300-1575-03
CONE, TRUCK.....7000-5090-01
DRUM, SMALL.....7300-1574-02
 Bumper, Small Drum.....7300-1645-01
 Drum Insert Assembly.....7300-1641-01
DRUM, LARGE.....7300-1574-01
 Bumper, Large Drum.....7300-1441-01
 Drum Insert Assembly.....7300-1641-01
WHEEL WEIGHT TOOL (PLIERS).....3300-0001-01

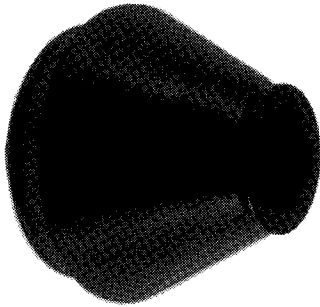

SMALL REVERSABLE CONE....7000-5080-01

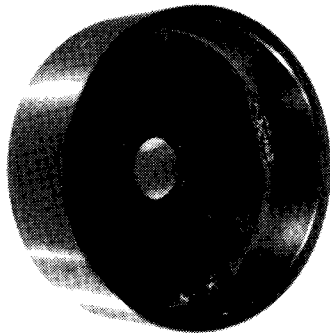

DEEP DISH OFFSET KIT.....7020-1772

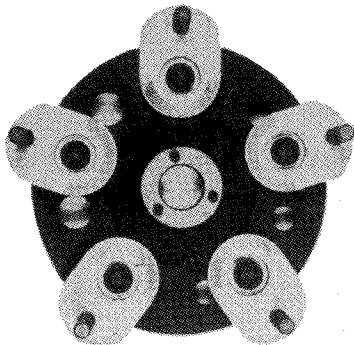

<u>DESCRIPTION/QTY</u>	<u>MODEL/PART#</u>
COMBI-ADAPTER KIT.....	7001
Combi-Adapter Assy/1.....	7100-3148-04
Face Plate Nuts/2.....	7000-6360-01
Wheel Lug Nuts/5.....	7000-6350-01
Lug Nut Wrench/1.....	7000-6200-01
Allen Wrench 1/4in./1.....	3302-0001-02

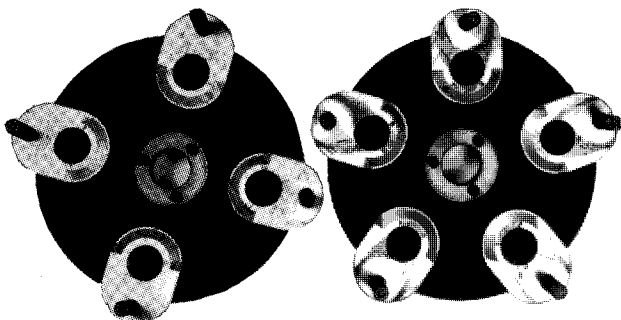

UNIVERSAL ADAPTER KIT.....	7002
4 Stud Adapter Assy/1.....	7000-7050-02
5 Stud Adapter Assy/1.....	7000-7040-02
Face Plate Nuts/2.....	7000-6360-01
Wheel Lug Nuts/5.....	7000-6350-01
Lug Nut Wrench/1.....	7000-6200-01

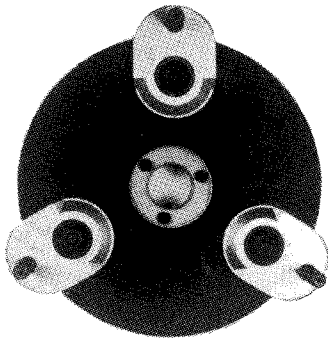

UNIV. 3 LUG ADAPTER KIT.....7003
3 Stud Adapter Assy/1....7000-7060-02
Face Plate Nuts/2.....7000-6360-01
Wheel Lug Nuts/3.....7000-6350-01
French Wheel Spacers/3...7000-8080-01
Lug Nut Wrench/1.....7000-6200-01

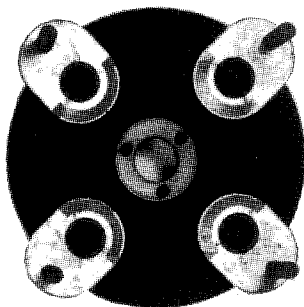

UNIV. 4 LUG ADAPTER KIT.....7004
4 Stud Adapter Assy/1....7000-7050-02
Face Plate Nuts/2.....7000-6360-01
Wheel Lug Nuts/4.....7000-6350-01
Lug Nut Wrench/1.....7000-6200-01

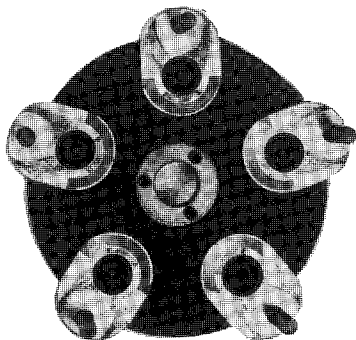

UNIV. 5 LUG ADAPTER KIT.....7005
5 Stud Adapter Assy/1....7000-7040-02
Face Plate Nuts/2.....7000-6360-01
Wheel Lug Nuts/5.....7000-6350-01
Lug Nut Wrench/1.....7000-6200-01



OVERSIZE LUG NUTS KIT.....7006
7/8in. Long Lug Nuts/6...7000-6840-01

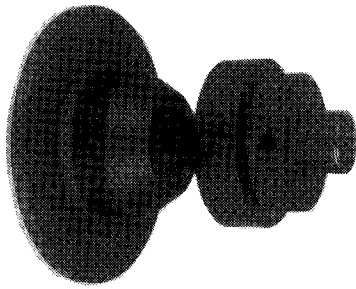

WIRE WHEEL ADAPTER.....7007
 Inner Cone & Shaft/1.....7000-7580-01
 Outer Cone/1.....7000-7570-01
 Locking Nut/1.....7000-7560-01
 Face Plate Nuts/2.....7000-6360-01

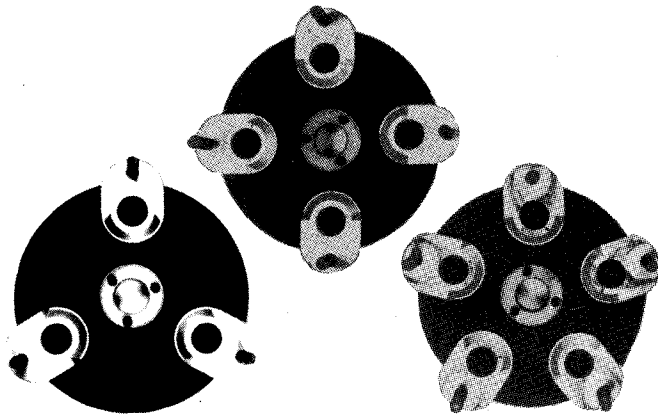

UNIV. ADAPTER KIT (3,4,5).....7009
 3 Stud Adapter Assy/1....7000-7060-02
 4 Stud Adapter Assy/1....7000-7050-02
 5 Stud Adapter Assy/1....7000-7040-02
 Face Plate Nuts/2.....7000-6360-01
 Wheel Lug Nuts/5.....7000-6350-01
 French Wheel Spacers/3...7000-8080-01
 Lug Nut Wrench/1.....7000-6200-01

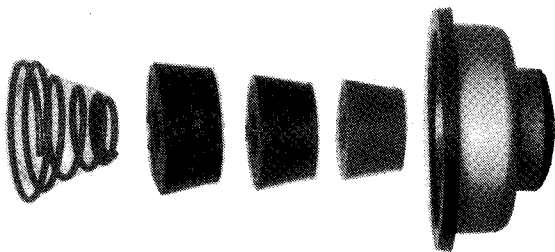

BACK CONE MOUNTING KIT.....7011
 Spring/1.....3825-0002-01
 Caution Tag/1.....7300-1533-01
 Drum Assembly Large/1....7300-1574-01
 Drum Assembly Small/1....7300-1574-02
 Small Cone/1.....7300-1575-01
 Medium Cone/2.....7300-1575-02
 Large Cone/1.....7300-1575-03
 Bumper Large/1.....7300-1441-01
 Bumper Small/1.....7300-1645-01
 No-Mar Ring/1.....7300-1597-01

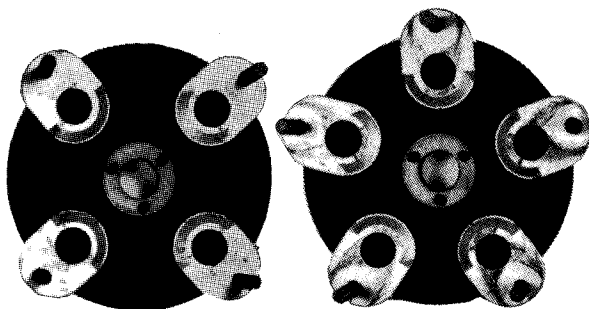

UNIV. ADAPTER KIT (4,5 METRIC)....7012
 4 Stud Adapter Assy/1....7300-1489-01
 5 Stud Adapter Assy/1....7300-1490-01
 Face Plate Nuts/2.....7000-6360-01
 Wheel Nuts Metric/5.....7300-1485-01
 Lug Nut Wrench/1.....7000-6200-01

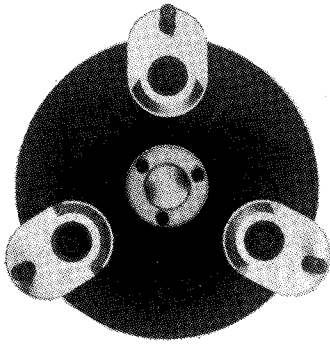

UNIV. 3 LUG ADAPTER (METRIC).....7013
3 Stud Adapter Assy/1....7300-1488-01
Face Plate Nuts/2.....7000-6360-01
Wheel Nuts Metric/3.....7300-1485-01
French Wheel Spacers/3...7000-8080-01
Lug Nut Wrench.....7000-6200-01

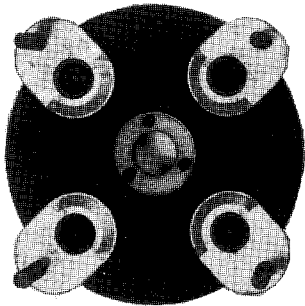

UNIV. 4 LUG ADAPTER (METRIC).....7014
4 Stud Adapter Assy/1....7300-1489-01
Face Plate Nuts/2.....7000-6360-01
Wheel Nuts Metric/4.....7300-1485-01
Lug Nut Wrench/1.....7000-6200-01

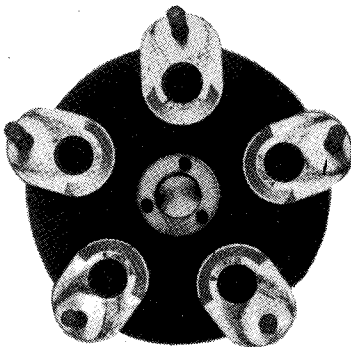

UNIV. 5 LUG ADAPTER (METRIC).....7015
5 Stud Adapter Assy/1....7300-1490-01
Face Plate Nuts/2.....7000-6360-01
Wheel Nuts Metric/5.....7300-1485-01
Lug Nut Wrench/1.....7000-6200-01



OVERSIZE LUG NUTS (10mm METRIC)...7016
7/8in. Long Lug Nuts/6...7300-1486-01

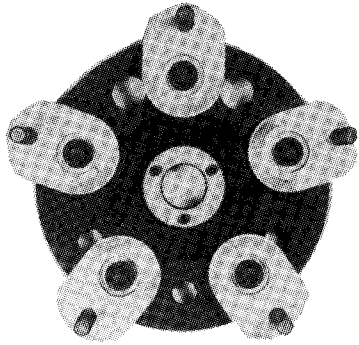

COMBI-ADAPTER (METRIC).....7017
 Combi-Adapter Assy/1.....7100-3148-05
 Face Plate Nuts/2.....7000-6360-01
 Wheel Nuts Metric/5.....7300-1485-01
 French Wheel Spacers/5...7000-8080-01
 Lug Nut Wrench.....7000-6200-01
 Allen Wrench 1/4in./1....3302-0001-02

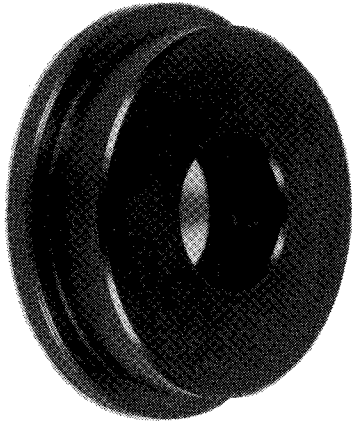

VW MOUNTING SYSTEM.....7018

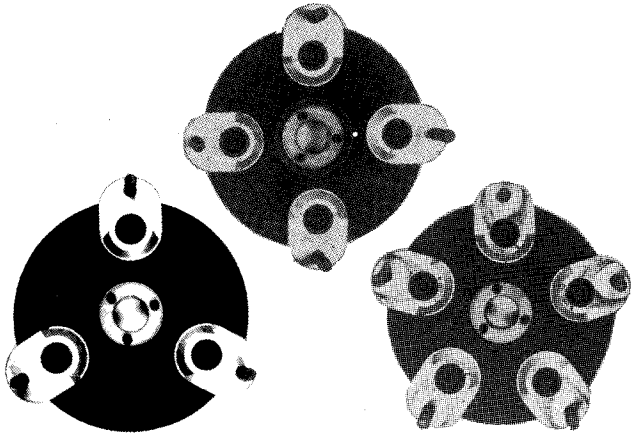

UNIV. ADAPTER KIT (3,4,5 METRIC)..7019
 3 Stud Adapter Assy/1....7300-1488-01
 4 Stud Adapter Assy/2....7300-1489-01
 5 Stud Adapter Assy/3....7300-1490-01
 Face Plate Nuts/2.....7000-6360-01
 Wheel Nuts Metric/5.....7300-1485-01
 French Wheel Spacers/3...7000-8080-01
 Lug Nut Wrench.....7000-6200-01

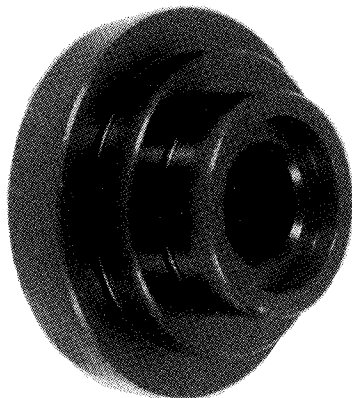

VW/PORSCHE MOUNTING KIT.....7021
 Includes VW Mounting/1.....7018

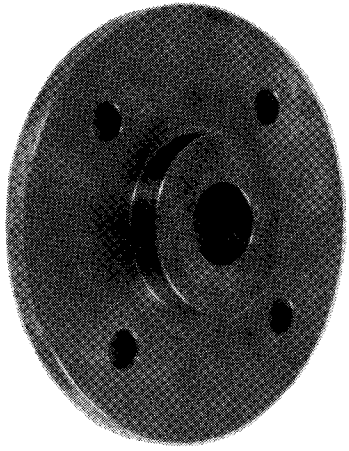

ESCORT/LYNX WHEEL ADAPTER.....7026



**SUN ELECTRIC
CORPORATION**

ONE SUN PARKWAY
CRYSTAL LAKE, ILLINOIS 60014

0692-9138 (9830)

© 1989 Sun Electric Corporation

Printed in U.S.A.

"FOR REFERENCE ONLY"